

### INSTALLATION INSTRUCTIONS

P21650, P21660, P24452, P24453,  
P24454, P24456, P24743, P24745,  
P24746, P24761, P24843

## INSTALLATION INSTRUCTIONS

## THANK YOU FOR CHOOSING KALLISTA

We appreciate your commitment to KALLISTA quality products. Please take a moment to review this manual before you install your KALLISTA product. If you encounter any installation or performance problems, please do not hesitate to contact us at the phone number listed at the bottom of the page.

## BEFORE YOU BEGIN

**⚠️ WARNING: Risk of scalding.** High water temperature can cause severe burns. Set the water temperature at or below 120°F (49°C) following the adjustment procedure in the valve Installation Instructions.

**⚠️ CAUTION: Risk of scalding.** KALLISTA low-flow showerheads/handshowers are designed for use with compatible KALLISTA valves. When installing a low-flow product to an existing showering system, verify compatibility before showering. Do not use this KALLISTA low-flow product with a shower valve that allows the water temperature to become too hot when other plumbing products are used.

Prior to using your shower, verify your new showerhead/ handshower is compatible with your shower valve (located behind the wall):

- While standing outside the shower, turn on the shower valve. Do not step into the shower.
- Adjust the water to your typical showering temperature.
- Have someone flush the nearest toilet.
- With your hand, carefully check the water temperature from the showerhead/handshower while the toilet is refilling.
- If the water becomes significantly more hot, you will need to replace the shower valve with a compatible KALLISTA valve or return your showerhead/handshower.

**NOTE:** Plumbing codes may require a vacuum breaker be installed in-line to handshowers. Please consult with local plumbing codes.

- Carefully plan the location of the wall supply elbow and fixed wall bracket to avoid the possibility of the handshower hose interfering with the operation of any faucets and/or drains, etc.
- Please read all instructions before you begin.
- Observe all local plumbing and building codes.
- Shut off the water supply.
- Inspect the supply piping for damage. Replace as necessary.
- KALLISTA reserves the right to make revisions in the design of products without notice, as specified in the Price Book.

### INSTALLATION INSTRUCTIONS

#### TOOLS AND MATERIALS

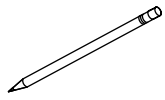

Pencil

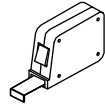

Tape Measure

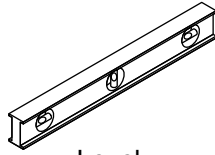

Level



Hex Wrench



Thread Sealant



Drill

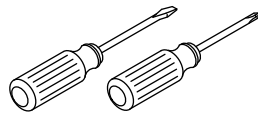

Assorted Screwdrivers

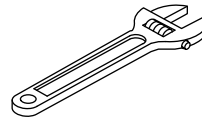

Adjustable Wrench

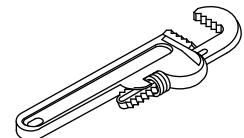

Pipe Wrench

#### 1. INSTALL THE SUPPLY ELBOW (P24452)

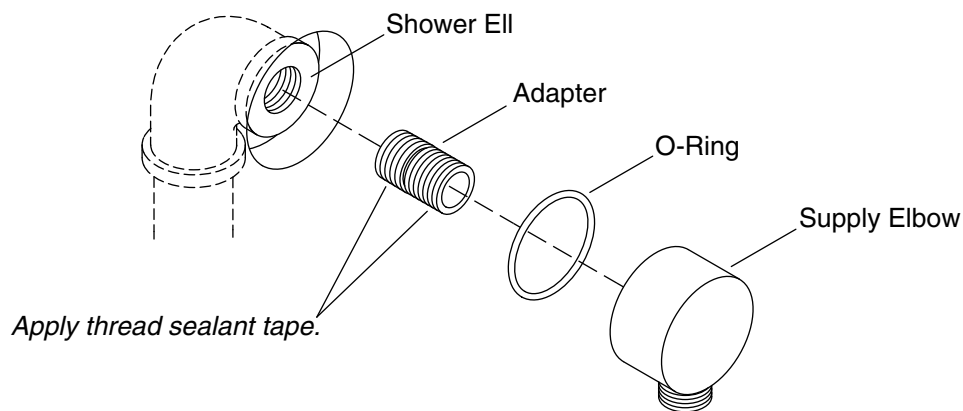

- Install a temporary nipple into the shower ell.
- Run water through the system to flush out dirt and debris.
- Remove the temporary nipple from the shower ell.
- Apply several layers of sealant tape around the straight end of the threaded adapter.
- Install the threaded adapter into the supply elbow.

**NOTE:** A hex wrench can be used to tighten the threaded adapter.

- Apply several layers of sealant tape around the exposed tapered end of the threaded adapter.
- Install the O-ring into the back of the supply elbow.
- Thread the adapter and supply elbow onto the shower ell.
- Turn on the water and allow water to flow through the supply elbow.
- Check connection for leaks. Repair as needed.

## INSTALLATION INSTRUCTIONS

### 2. INSTALL THE FIXED WALL BRACKET (P24453)

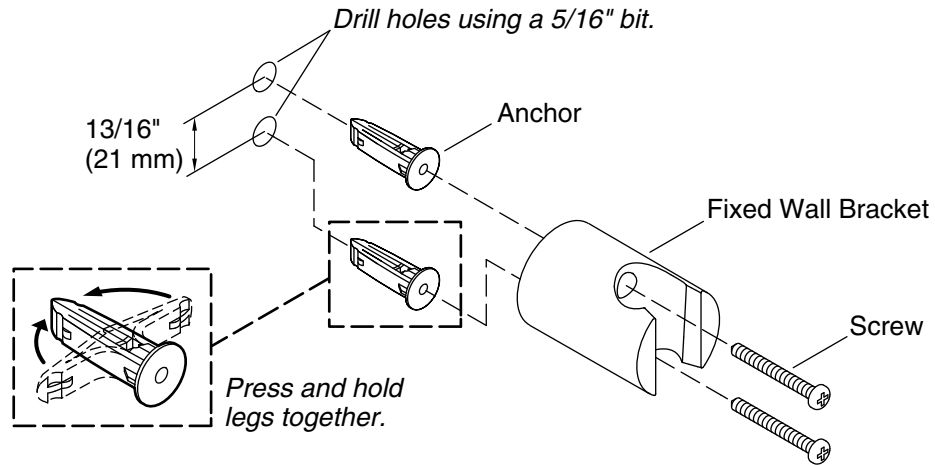

- Determine the location for the fixed wall bracket.
- Mark the hole locations for the wall anchors.
- Drill the holes and install the wall anchors.
- Attach the fixed wall bracket to the wall with the screws.

### 3. INSTALL THE HANDSHOWER AND HOSE

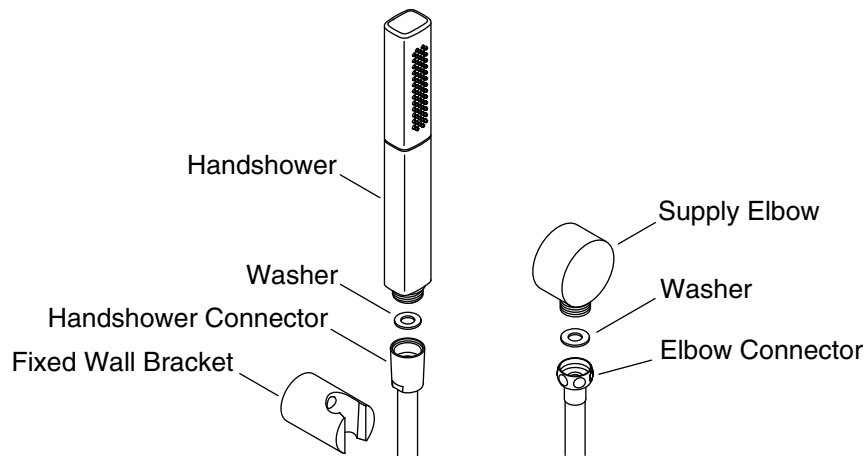

- Insert a washer into the elbow connector end of the shower hose.
- Attach the shower hose to the supply elbow. Run cold and hot water through the shower hose to flush out dirt and debris.
- Insert the other washer into the threads of the handshower connector.
- Thread the handshower into the shower hose. Tighten with an adjustable wrench.
- Turn on the water. Check for leaks and smooth operation.
- Place the handshower in the fixed wall bracket.

### INSTALLATION INSTRUCTIONS

#### 4. INSTALL THE OPTIONAL SLIDEBAR (P24456)

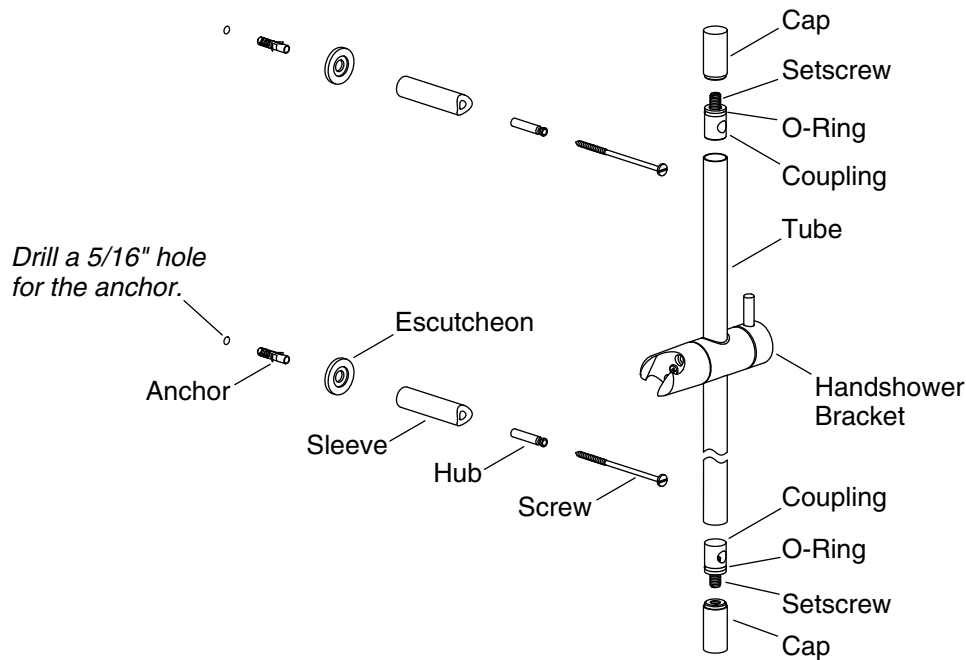

- Determine the location for the slidebar.
- Mark the hole locations for the wall anchors.
- Drill the holes and install the wall anchors.
- Attach the escutcheons, sleeves, and hubs with the screws.
- Slide the handshower bracket onto the tube.
- Insert the couplings into the ends of the tube. Line up the holes in the tube with the holes in the couplings.
- Place the tube over the sleeves.
- Tighten the setscrews so they engage with the groove in the hubs.
- Screw the caps onto the exposed ends of the setscrews.